

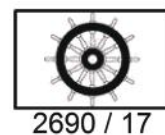

High Value Sound Reduction Class B-15 Bulkhead Panel (50mm)















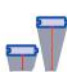
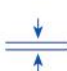

*Panels are fitted into each others.
Strong and smooth continuous wall form.*



2690 / 17



Technical Characteristics of High Value Sound Reduction Class B-15 Bulkhead Panel (50mm)

-  **Fire Class** : B-15
-  **Thickness** : 50 mm
-  **Width** : 500 mm (\pm 1 mm)
-  **Standart Length** : 2200 mm (\pm 3 mm)
-  **Manufacturable Length** : 1000 ~ 2465 mm (\pm 3 mm)
-  **Steel Thickness** : 0,6 mm
-  **Finish Surface** : PVC/PVC or SS/SS or GLV/GLV or PAINTED/PAINTED
-  **PVC Film** : PVC film has "low flame spread" certificate
-  **Insulation Materials** : Mineral Wool - Rockwool / Denmark
-  **Density of Rockwool** : 180 kg/m³
-  **Sound Reduction Ability R_w** : Only Panel 40,1 dB
-  **Weight** : 20 kg/m²
-  **Application** : It is used as bulkhead panel
-  **Certificate [IMO Resolution A.754(18)]** :  Flag Authority (TC Maritime Undersecretary)

Sound Insulation Diagram

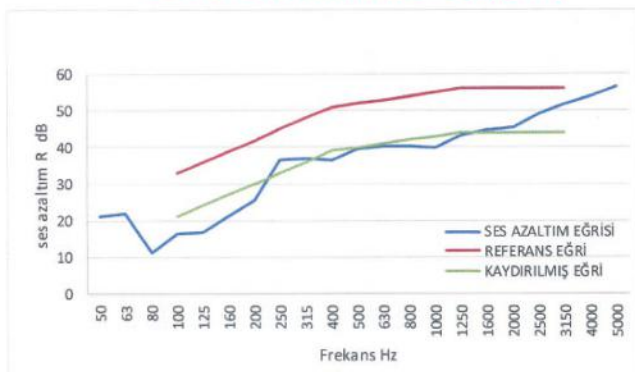

Bureau Veritas



Turk Loydu



MED Marine Equipment Directive (EC)



Russian Maritime Register of Shipping

Assembling of High Value Sound Reduction Class B-15 Bulkhead Panel (50mm)

Corner Detail

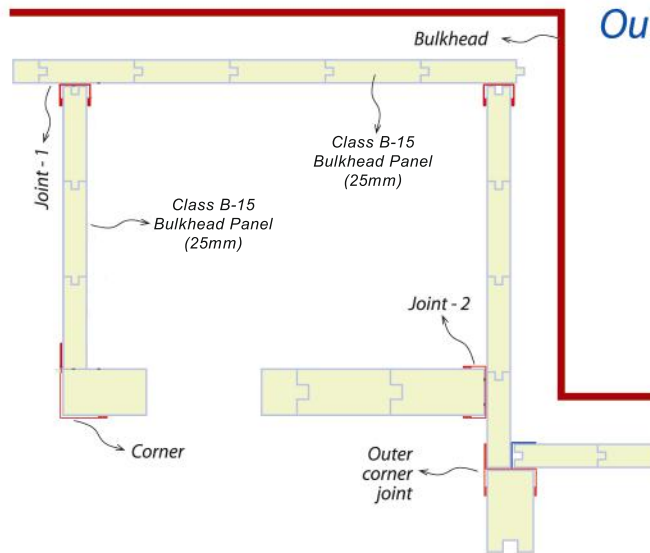
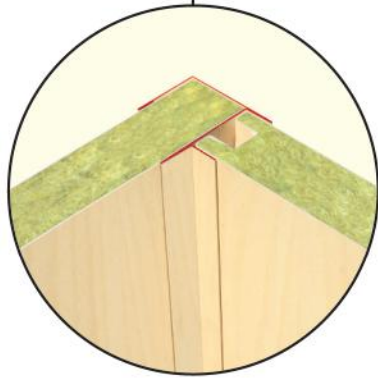
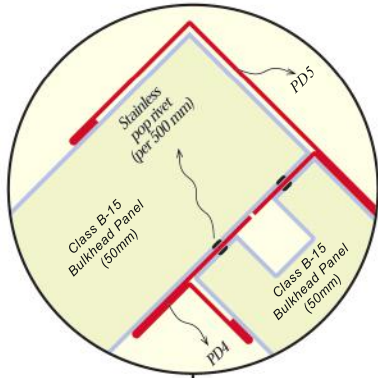

Outer Corner Assembling Detail

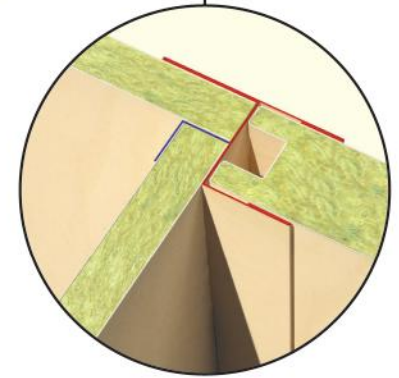
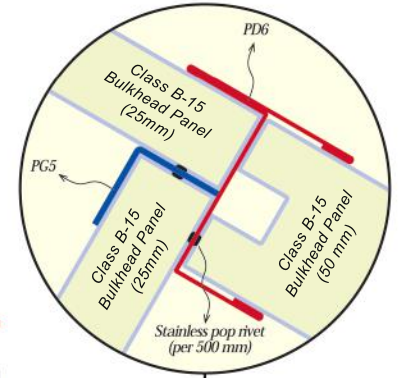

Assembling Vertical Section

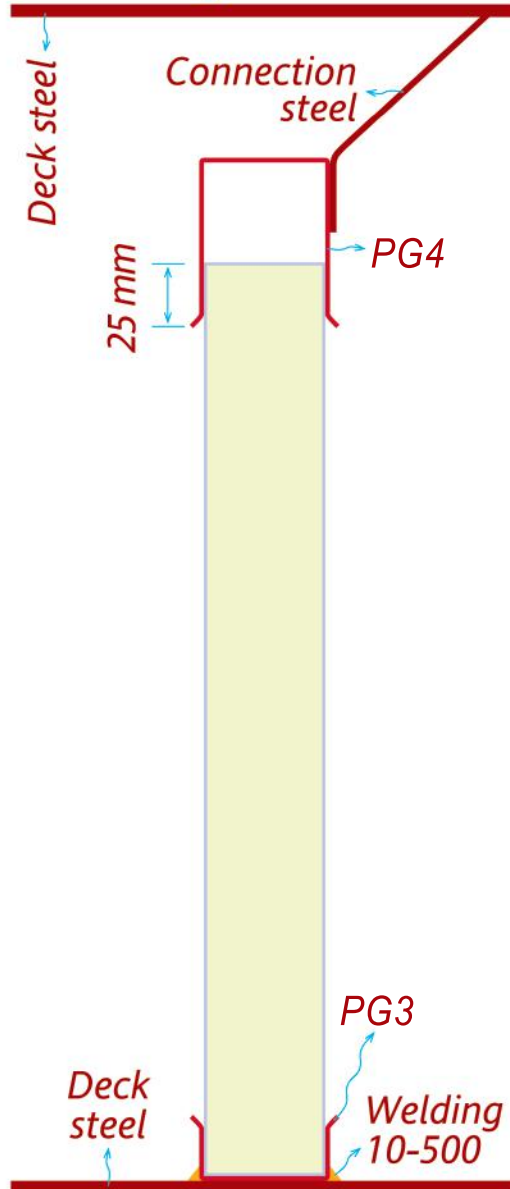

Joint Detail - 1

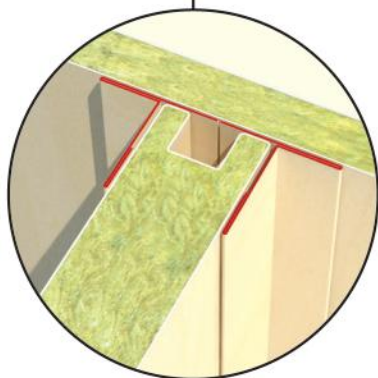
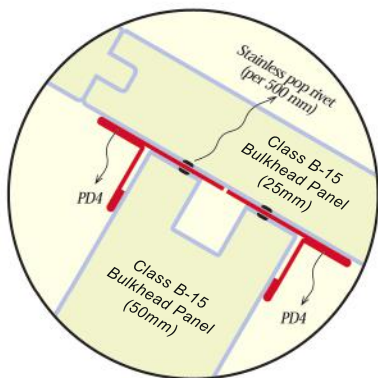

Joint Detail - 2

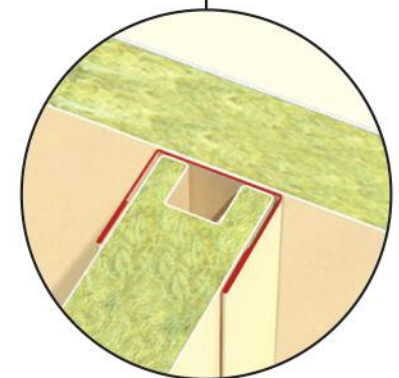
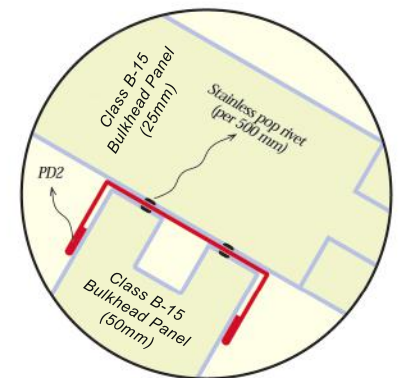

Advantages of High Value Sound Reduction Class B-15 Bulkhead Panel (50mm)

**Fast and easy
assembling.**

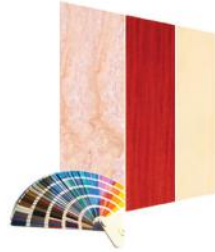

**Plenty of
color choice.**

Surface would be **PVC,
stainless or galvanized steel.**



**Standart length
manufacturing.
Available to produce
required size.**

**Vertical mounting
fitted into each others.**

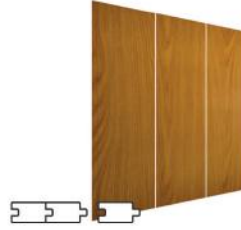

PVC surfaces are
covered with a
protective film against
dirty and scratching.

Vertical mounting fitted into each others kind, gives important advantages:

Connected areas are
only one regular line
wall surface is smooth.

Strong and
became partially
carrier spect.

No noise
when
vibration.

No corrosion because
of not touching to
steel to steel.

Much effective
sound and fire
insulation.

