

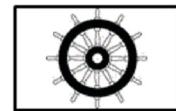

B-15 Tipi Duvar Paneli















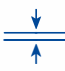

*Geçmeli tip panellerdir.
Sağlam ve pürüzsüz bir duvar oluştururlar.*



2690 / 17



B-15 Tipi Duvar Panellerinin Teknik Özellikleri

-  **Yangın Sınıfı** : B-15
-  **Kalınlık** : 50 mm
-  **Genişlik** : 500 mm (± 1 mm)
-  **Standart Boy** : 2200 mm (± 3 mm)
-  **Üretilbilir Boy** : 1000 ~ 2465 mm (± 3 mm)
-  **Sac Kalınlığı** : 0,6 mm
-  **Panel Yüzeyi** : PVC/PVC veya PSL/PSL veya GLV/GLV
-  **PVC Film** : PVC film “düşük alev yayma” sertifikalıdır.
-  **İzolasyon Malzemesi** : Kayayünü - Rockwool / Denmark
-  **Kayayünü Yoğunluğu** : 130 kg/m³
-  **Ses Yalıtım Yeteneği R_w** : 29 dB
-  **Ağırlık** : 17,6 kg/m²
-  **Uygulama** : Bölme paneli olarak kullanılır.
-  **Sertifika** :  Bayrak Otoritesi (TC Denizcilik Müsteşarlığı)

Ses Yalıtım Grafiği

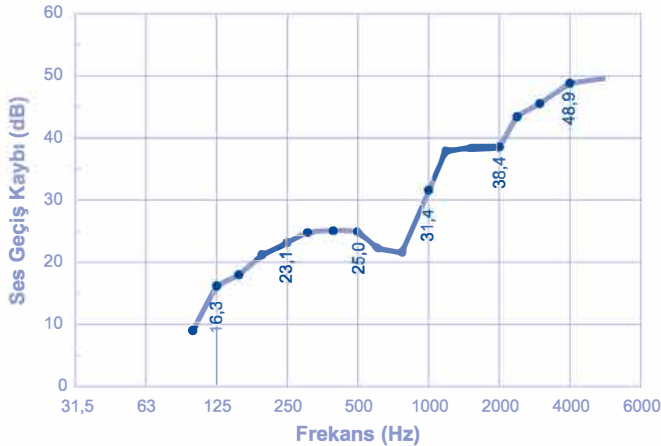

Fransız Loydu (Bureau Veritas)



Türk Loydu



M.E.D. Marine Equipment Directive (EC)

B-15 Tipi Duvar Panellerinin Montajı

Köşe Detayı

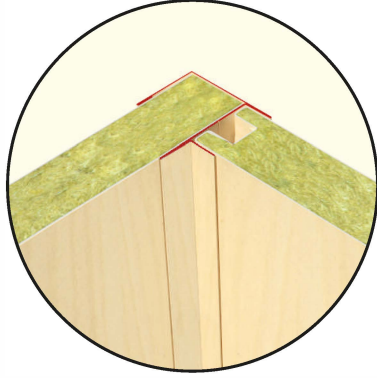
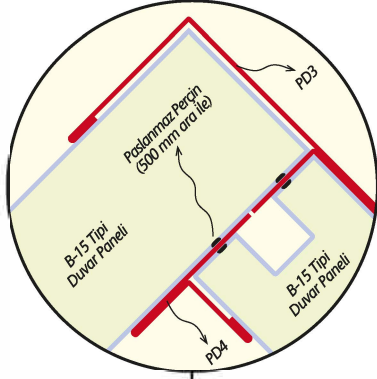

Dış Köşe Birleşim Detayı

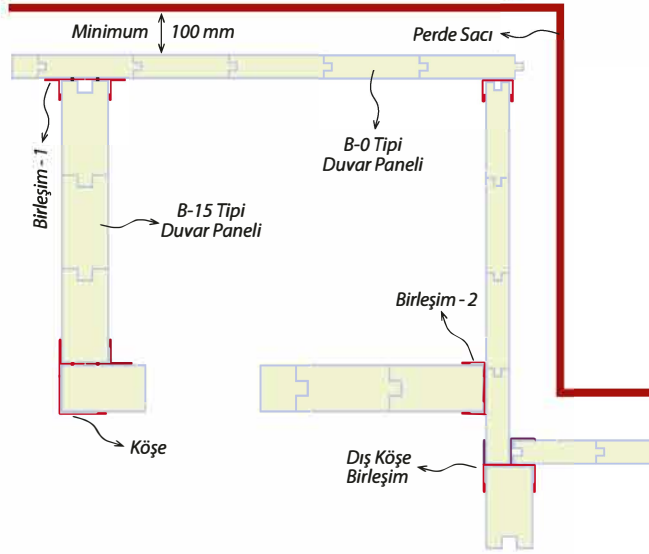
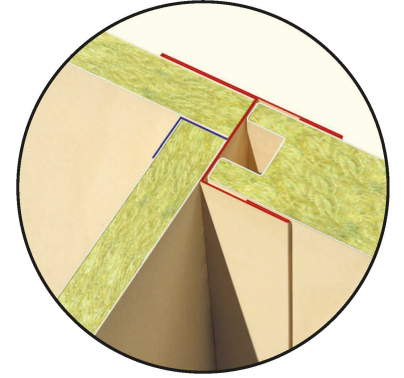
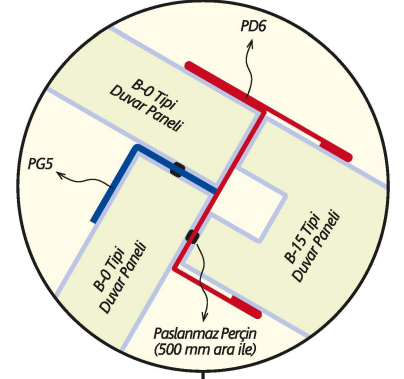

Montaj Düşey Kesit

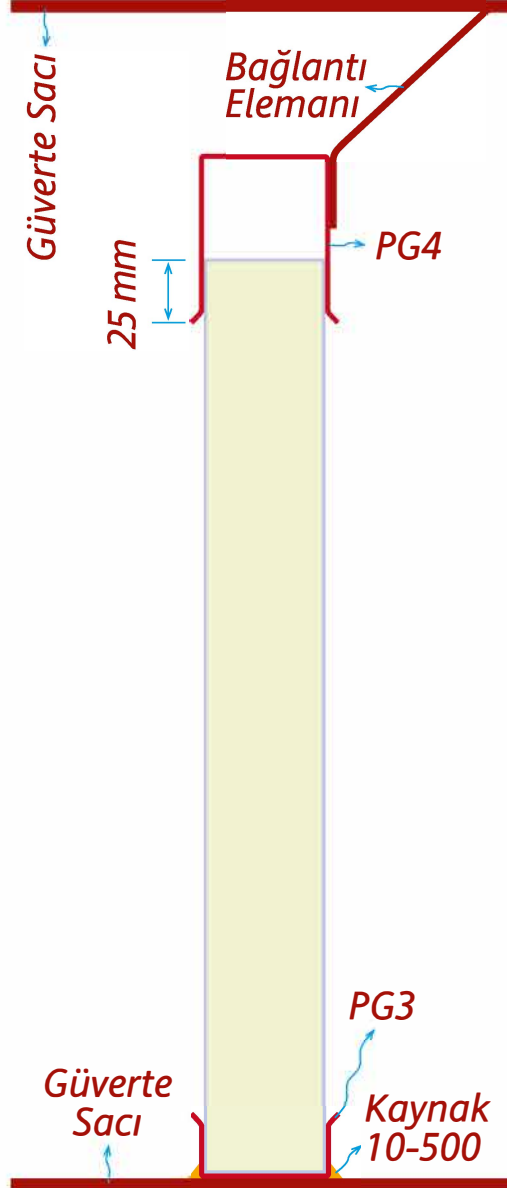

Birleşim Detayı - 1

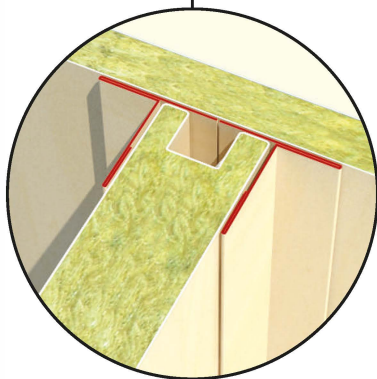
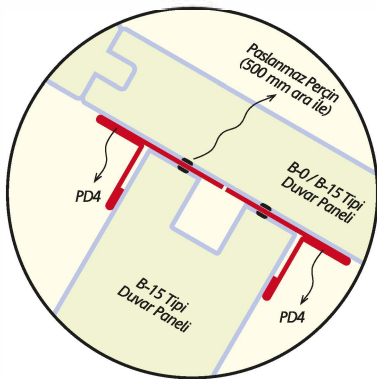

Birleşim Detayı - 2

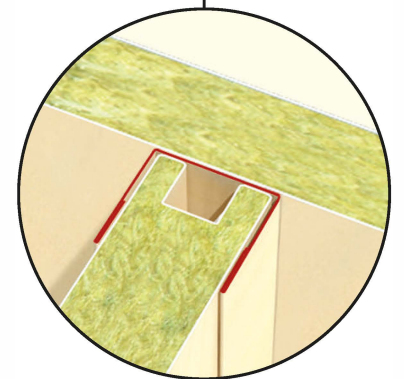
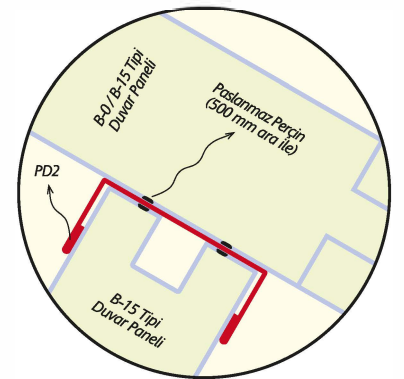

B-15 Tipi Duvar Panellerinin Avantajları

Çabuk ve kolay
monte edilir.

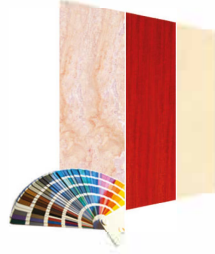

Zengin renk
seçenekleri mevcuttur.

Yüzey; **PVC, Paslanmaz**
veya **Galvaniz** olabilir.



Standart boyutlarda
üretilmektedir.
İstenilen boyutta
üretim yapılabilir.

Düşey bağlantı yapısı
geçmeli tiptir.

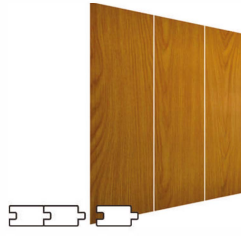

PVC yüzeyler,
kirlenme ve çizilmeye karşı,
koruyucu film
ile kaplanmıştır.

Düşey bağlantı yapısının geçmeli tip olması, önemli avantajlar sağlar:

Ek yerleri tek
çizgili, duvar yüzeyi
pürüzsüzdür.



Sağlamdır ve
kısmen taşıyıcı
özellik kazanmıştır.

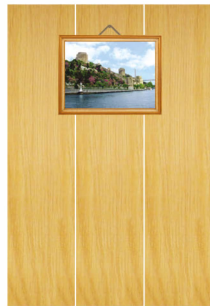

Titreşimde
ses
yapmaz



Sac saca temas
etmediği için
korozyona uğramaz



Daha etkin
bir ses ve ısı
yalıtımı sağlar.

