

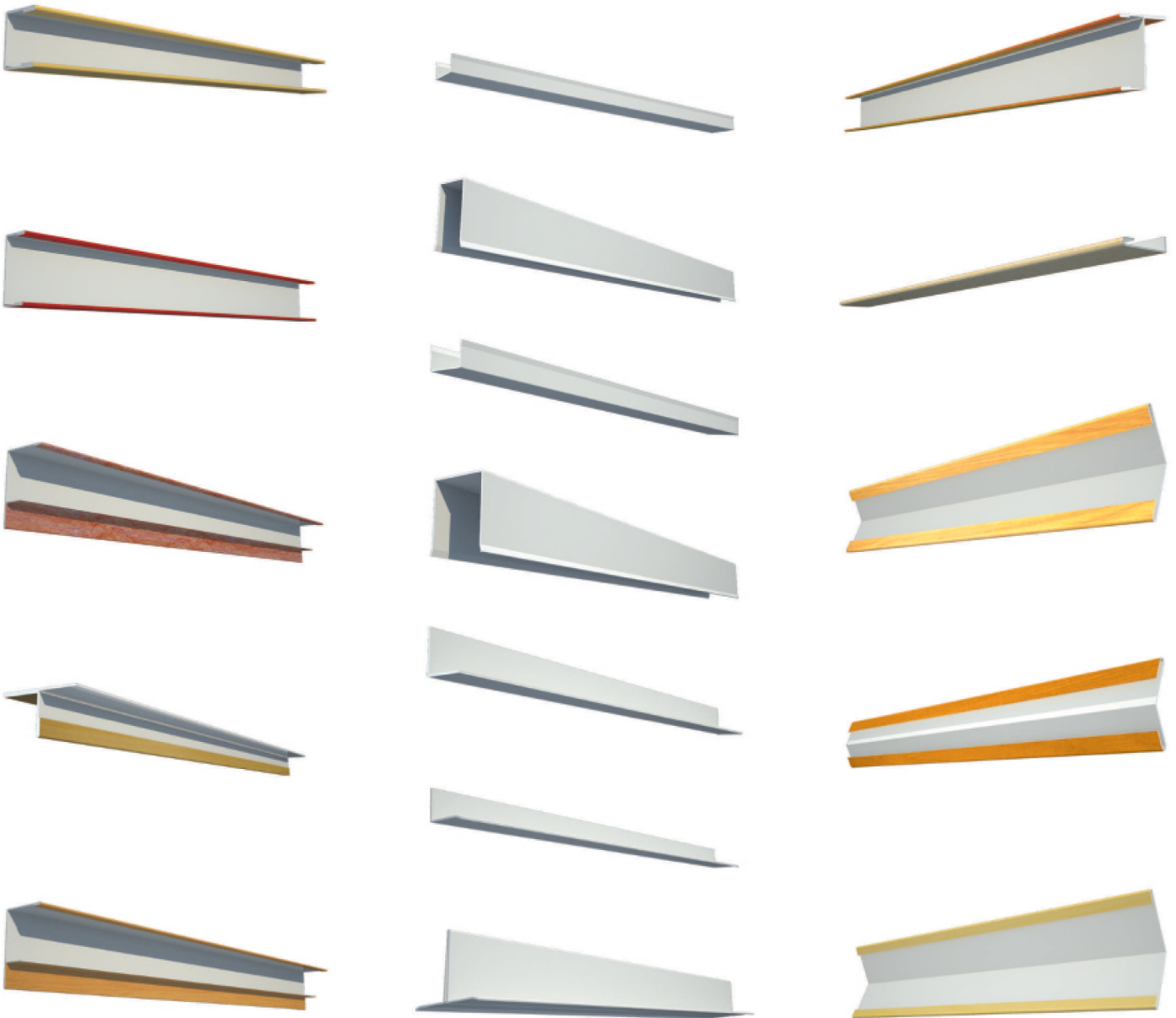

## *Profiles*

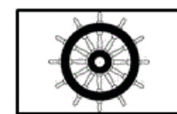

*These are panel fixing parts.*



2690 / 17



## Decorative Profiles (PD)

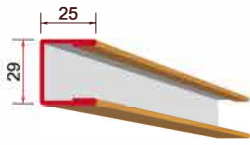

### PD1 - End Profile

End cap profile for Class B-0 lining panels connects to the other panel.

**Weight: 0,45 kg/m**

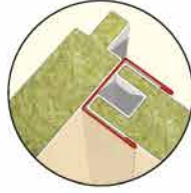

Decorative profiles are made of PVC laminated galvanized steel sheets. They are produced with the same color and length of panel. They are used for fixing parts for panels mounting. Thickness is 0,6 mm.

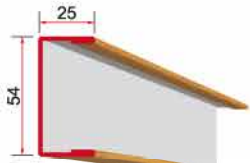

### PD2 - End Profile

End cap profile for Class B-15 partition panels connects to the other panel.

**Weight: 0,55 kg/m**

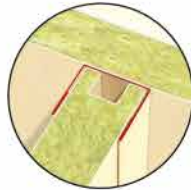

### PD9 - Joint Cover Profile

Covering profile of PG1 profiles where longitudinally added on Class B-0 lining panels.

**Weight: 0,40 kg/m**

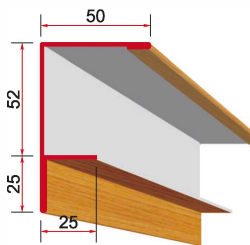
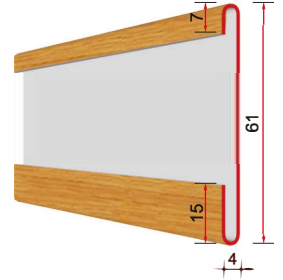
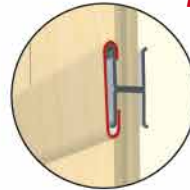

### PD3 - External Corner Profile

External corner profiles for connection of Class B-15 partition panels.

**Weight: 0,87 kg/m**

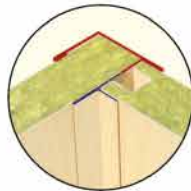

### PD10 - Covering Profile

Covering profile of PG7 and PG8 which are used for fixing Class B-0 ceiling panels.

**Weight: 0,28 kg/m**

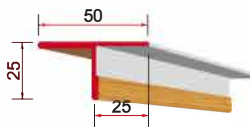
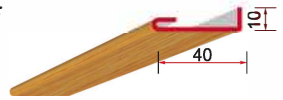
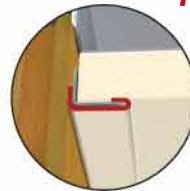

### PD4 - Internal Corner Profile

Internal corner profile for fixing Class B-0 and/or Class B-15 wall panels.

**Weight: 0,52 kg/m**



### PD11 - Angled Outer Corner Profile

External hiding profile of PG1 profiles where angled connections of Class B-0 lining panels.

**Weight: 0,53 kg/m**

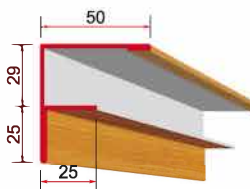
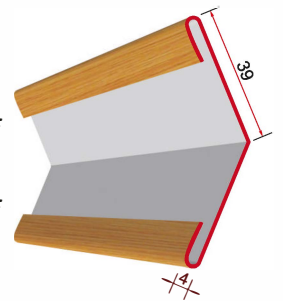
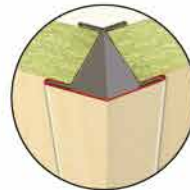

### PD5 - External Corner Profile

External corner profile for fixing Class B-0 lining panels.

**Weight: 0,76 kg/m**

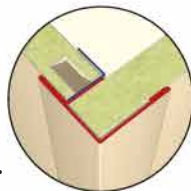

### PD12 - Angled Inner Corner Profile

Inner hiding profile of PG1 or PG3 profiles where angled connections of Class B-0 or B-15 wall panels.

**Weight: 0,41 kg/m**

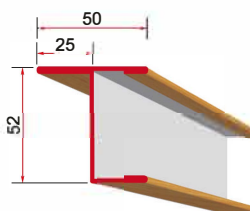
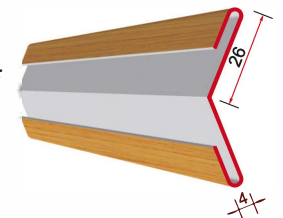
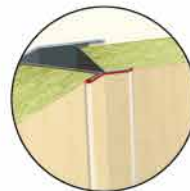

### PD6 - Corner Profile

Corner profile for fixing Class B-15 partition panel where adjacent corner of Class B-0 lining panels.

**Weight: 0,81 kg/m**

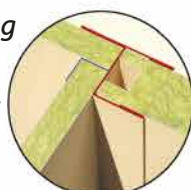

### PD13 - Angled Outer Corner Profile

External hiding profile of PG3 profile where angled connections of two Class B-15 partition panels.

**Weight: 0,67 kg/m**

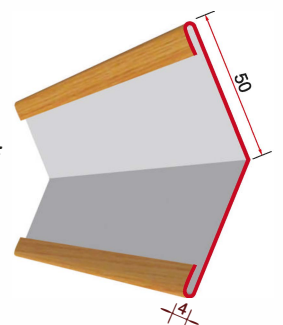

# Stainless Steel Profiles (PP)

Stainless steel profiles are made of stainless steel sheets. They are produced with the same length of panels. They are using for fixing of mounting of panels. Thickness is 0,5 mm

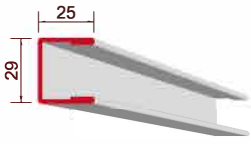

### PP1 - End Profile

End cap profile for Class B-0 lining panels connects to the other panel.

**Weight: 0,38 kg/m**

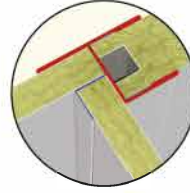
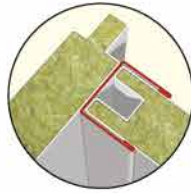

### PP6 - Corner Profile

Corner profile for fixing Class B-15 partition panel where adjacent corner of Class B-0 lining panels.

**Weight: 0,68 kg/m**

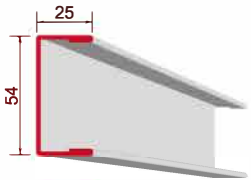
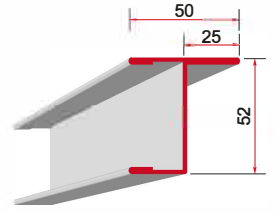

### PP2 - End Profile

End cap profile for Class B-15 partition panels connects to the other panel.

**Weight: 0,48 kg/m**

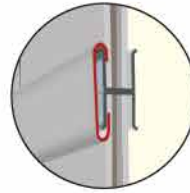
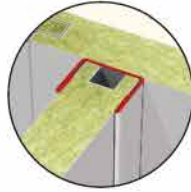

### PP9 - Joint Cover Profile

Covering profile of PG1 profiles where longitudinally added on Class B-0 lining panels.

**Weight: 0,33 kg/m**

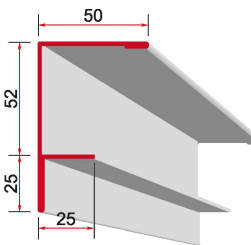
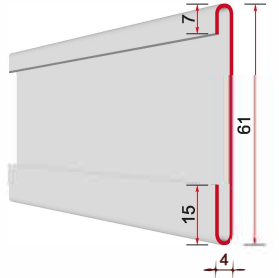

### PP3 - External Corner Profile

External corner profiles for connection of Class B-15 partition panels.

**Weight: 0,74 kg/m**

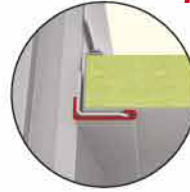
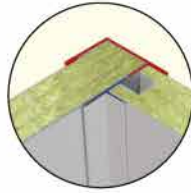

### PP10 - Covering Profile

Covering profile of PG7 and PG8 which are used for fixing Class B-0 ceiling panels.

**Weight: 0,24 kg/m**

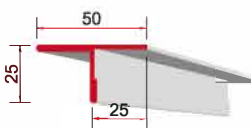
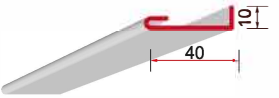

### PP4 - Internal Corner Profile

Internal corner profile for fixing Class B-0 and/or B-15 wall panels.

**Weight: 0,44 kg/m**

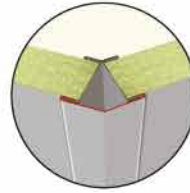
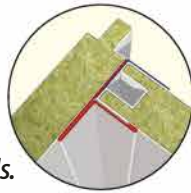

### PP11 - Angled Outer Corner Profile

External hiding profile of PG1 profiles where angled connections of Class B-0 lining panels.

**Weight: 0,44 kg/m**

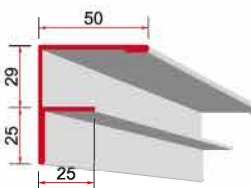
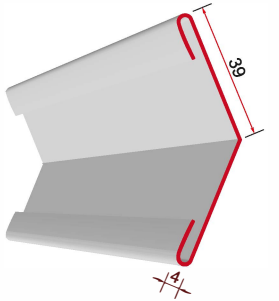

### PP5 - External Corner Profile

External corner profile for fixing Class B-0 lining panels.

**Weight: 0,64 kg/m**

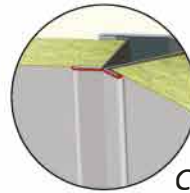
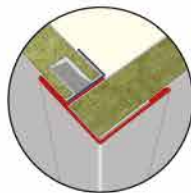

### PP12 - Angled Inner Corner Profile

Inner hiding profile of PG1 or PG3 profiles where angled connections of Class B-0 or B-15 wall panels.

**Weight: 0,34 kg/m**

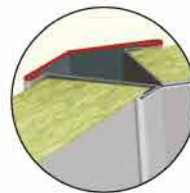
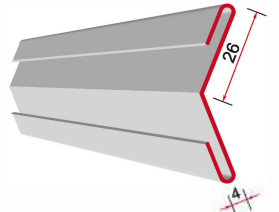

### PP13 - Angled Outer Corner Profile

External hiding profile of PG3 profile where angled connections of two Class B-15 partition panels.

**Weight: 0,56 kg/m**

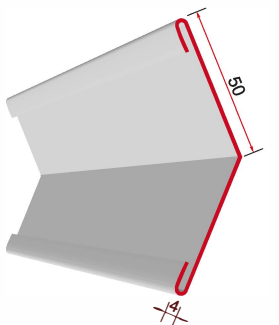



## Galvanized Profiles (PG)

Galvanized profiles are made of galvanized steel sheets. They are used for fixing of panels mounting. Thickness is 1,5 mm. They are produced 2400 mm standart lenght. Galvanized profiles are welded directly to desk steel or by using a connection part.

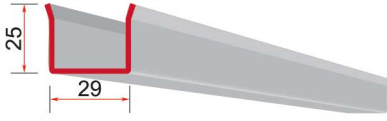

### PG1 - Bottom U Profile

It is used for fixing Class B-0 lining panel to ground steel.

**Weight:** 0,90 kg/m

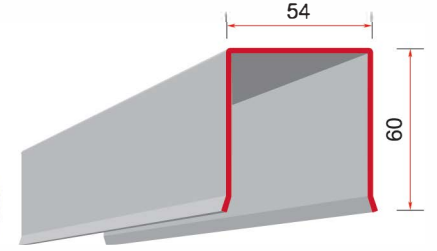
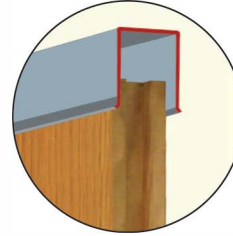
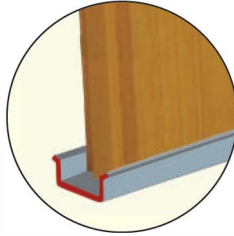

### PG4 - Top U Profile

It is used for fixing Class B-15 partition panels to deck steel.

**Weight:** 2,01 kg/m

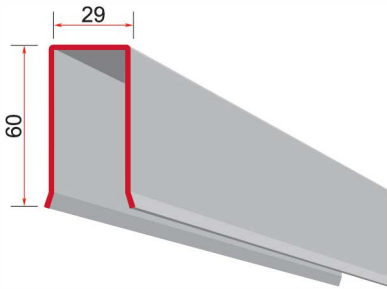

### PG2 - Top U Profile

It is used for fixing Class B-0 lining panel to deck steel.

**Weight:** 1,72 kg/m

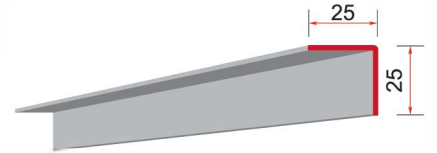
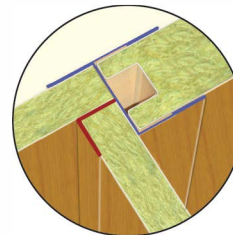
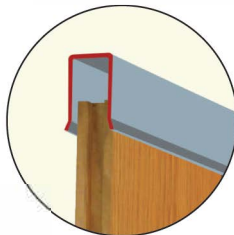

### PG5 - Angled Profile

Multi purposes and supporting profile.

**Ağırlık:** 0,55 kg/m

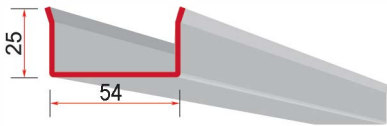

### PG3 - Bottom U Profile

It is used for fixing Class B-15 partition panel to deck steel.

**Weight:** 1,20 kg/m

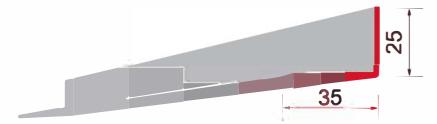
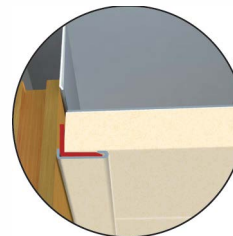
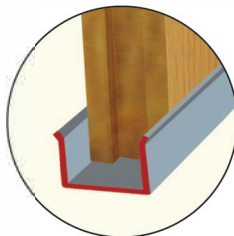

### PG7 - Edge L Profile

Ceiling-Wall connections profile.

**Weight:** 0,67 kg/m

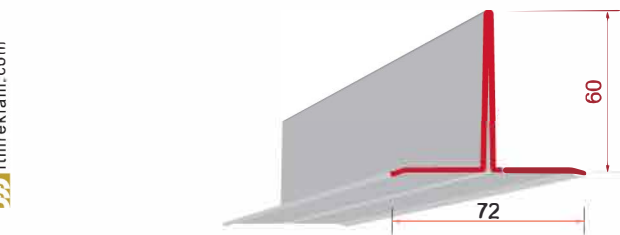

### PG8 - T Carrier Profile

It is used as a carrier profile of ceiling panels where longitudinally connections places.

**Weight:** 2,13 kg/m

