

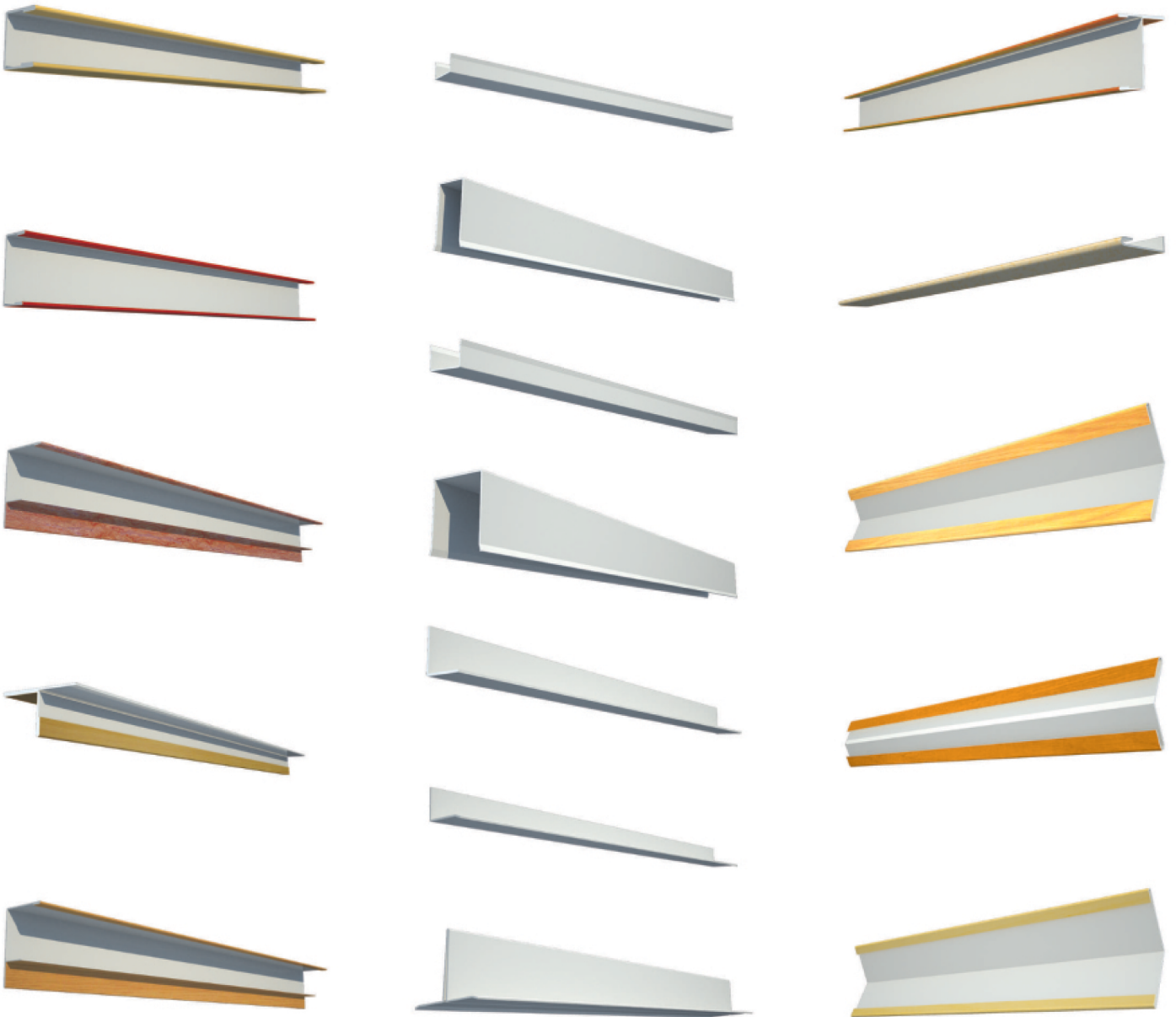

## *Profiller*

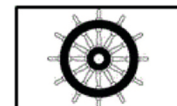

*Panel bağlantı elemanlarıdır.*



2690 / 17



## Dekoratif Profiller (PD)

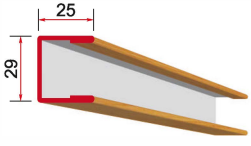

### PD1 - Alın Profili

B-0 tipi duvar panelini diğer bir duvara bağlayan elemandır.  
**Ağırlık: 0,45 kg/m**

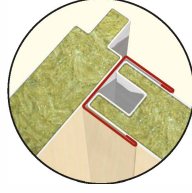

Dekoratif Profiller, PVC kaplı galvaniz sacdan yapılır. Paneller ile aynı renk ve boyda üretilir. Panellerin montajında bağlantı elemanı olarak kullanılır. Sac kalınlığı 0,6 mm'dir.

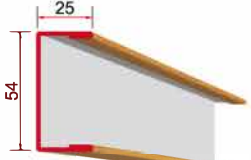

### PD2 - Alın Profili

B-15 tipi duvar panelini diğer bir duvara bağlayan elemandır.  
**Ağırlık: 0,55 kg/m**

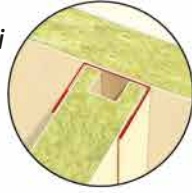

### PD9- Ek Gizleme Profili

B-0 tipi duvar panellerinin boyuna ek yerlerinde kullanılan PG1 profillerini gizleyen elemandır.  
**Ağırlık: 0,40 kg/m**

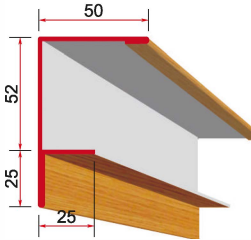
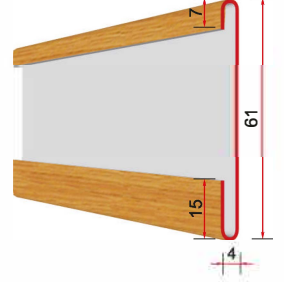
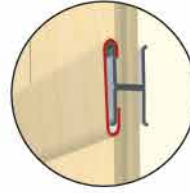

### PD3 - Dış Köşe Profili

B-15 tipi duvar panellerinin, dış köşe bağlantı elemanıdır.  
**Ağırlık: 0,87 kg/m**

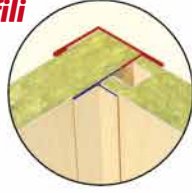

### PD10 - Gizleme Profili

B-0 tipi tavan panellerinin montajında kullanılan PG7 ve PG8 galvaniz profillerini gizleyen elemandır.  
**Ağırlık: 0,28 kg/m**

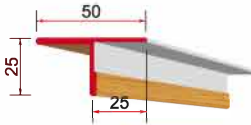
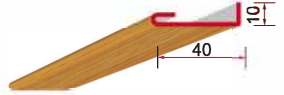
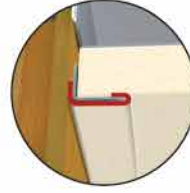

### PD4 - İç Köşe Profili

B-0 ve/veya B-15 tipi duvar panellerinin iç köşe bağlantı elemanıdır.  
**Ağırlık: 0,52 kg/m**



### PD11 - Açılı Dış Köşe Profili

Açılı birleşen B-0 tipi duvar panellerinin alınlarına yerleştirilen PG1 profillerini dıştan gizleyen elemandır.  
**Ağırlık: 0,53 kg/m**

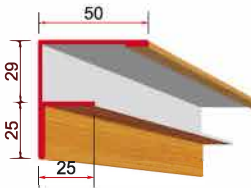
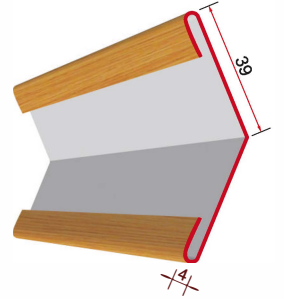
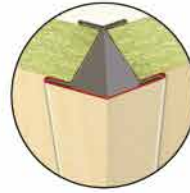

### PD5 - Dış Köşe Profili

B-0 tipi duvar panellerinin dış köşe bağlantı elemanıdır.  
**Ağırlık: 0,76 kg/m**

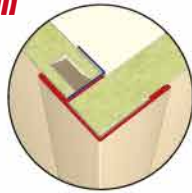

### PD12 - Açılı İç Köşe Profili

Açılı birleşen B-0 veya B-15 tipi duvar panellerinin alınlarına yerleştirilen PG1 veya PG3 profillerini içten gizleyen elemandır.  
**Ağırlık: 0,41 kg/m**

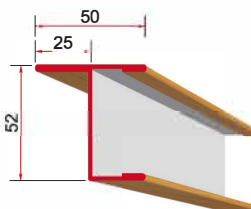
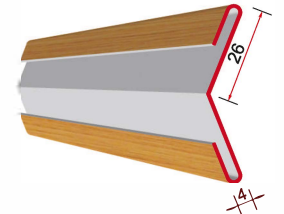
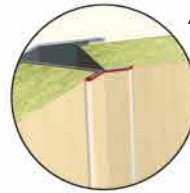

### PD6 - Köşe Profili

B-0 tipi duvar panellerinin oluşturduğu köşeye B-15 tipi duvar panelini bağlayan elemandır.  
**Ağırlık: 0,81 kg/m**

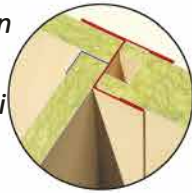

### PD13 - Açılı Dış Köşe Profili

Açılı birleşen B-15 tipi duvar panellerinin alınlarına yerleştirilen PG3 profillerini dıştan gizleyen elemandır.  
**Ağırlık: 0,67 kg/m**

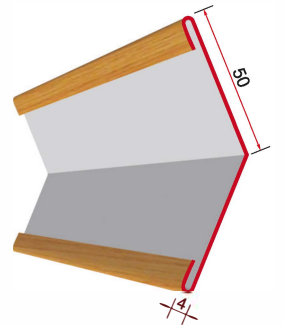
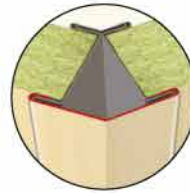

## Paslanmaz Profiller (PP)

Paslanmaz Profiller, paslanmaz sacdan yapılır. Paneller ile aynı boyda üretilir. Panellerin montajında bağlantı elemanı olarak kullanılır. Sac kalınlığı 0,5 mm'dir.

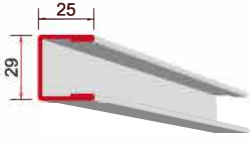

### PP1 - Alın Profili

B-0 tipi duvar panelini diğer bir duvara bağlayan elemandır.  
**Ağırlık: 0,38 kg/m**

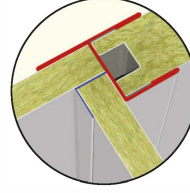
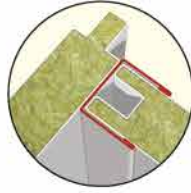

### PP6- Köşe Profili

B-0 tipi duvar panelinin oluşturduğu köşeye B-15 tipi duvar panelini bağlayan elemandır.  
**Ağırlık: 0,68 kg/m**

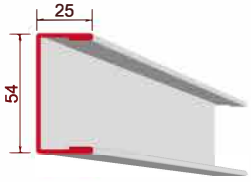
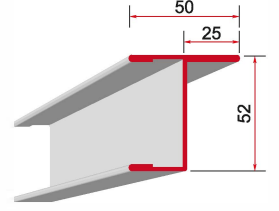

### PP2 - Alın Profili

B-15 tipi duvar panelini diğer bir duvara bağlayan elemandır.  
**Ağırlık: 0,48 kg/m**

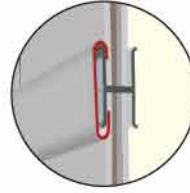
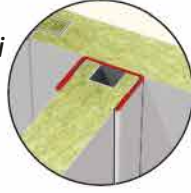

### PP9- Ek Gizleme Profili

B-0 tipi duvar panelinin boyuna ek yerlerinde kullanılan PG1 profillerini gizleyen elemandır.  
**Ağırlık: 0,33 kg/m**

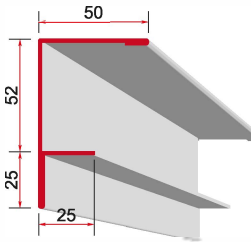
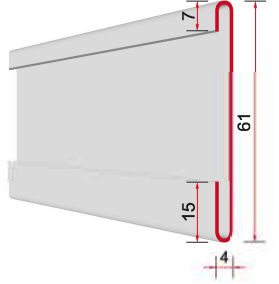

### PP3 - Dış Köşe Profili

B-15 tipi duvar panelinin, dış köşe bağlantı elemanıdır.  
**Ağırlık: 0,74 kg/m**

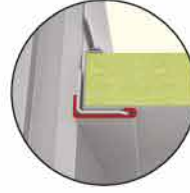
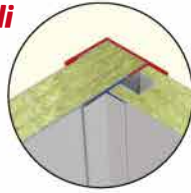

### PP10 - Gizleme Profili

B-0 tipi tavan panelinin montajında kullanılan PG7 ve PG8 galvaniz profillerini gizleyen elemandır.  
**Ağırlık: 0,24 kg/m**

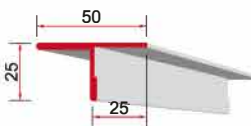
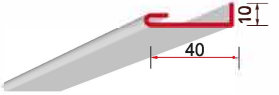

### PP4 - İç Köşe Profili

B-0 ve/veya B-15 tipi duvar panelinin iç köşe bağlantı elemanıdır.  
**Ağırlık: 0,44 kg/m**

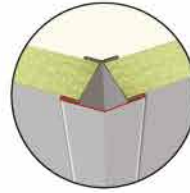
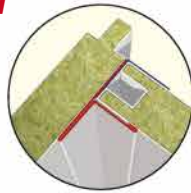

### PP11 - Açılı Dış Köşe Profili

Açılı birleşen B-0 tipi duvar panelinin alınlarına yerleştirilen PG1 profillerini dıştan gizleyen elemandır.  
**Ağırlık: 0,44 kg/m**

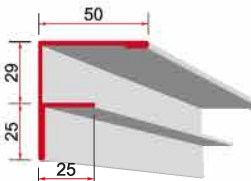
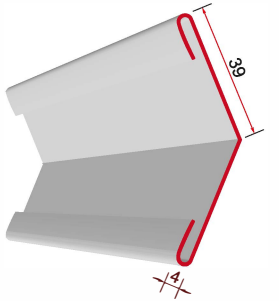

### PP5 - Dış Köşe Profili

B-0 tipi duvar panelinin dış köşe bağlantı elemanıdır.  
**Ağırlık: 0,64 kg/m**

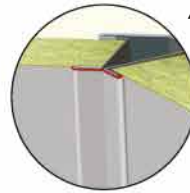
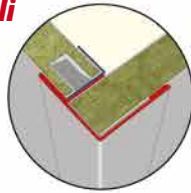

### PP12 - Açılı İç Köşe Profili

Açılı birleşen B-0 veya B-15 tipi duvar panelinin alınlarına yerleştirilen PG1 veya PG3 profillerini içten gizleyen elemandır.  
**Ağırlık: 0,34 kg/m**

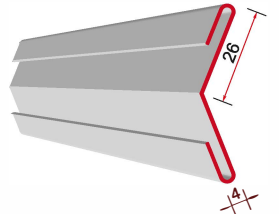

### PP13 - Açılı Dış Köşe Profili

Açılı birleşen B-15 tipi duvar panelinin alınlarına yerleştirilen PG3 profillerini dıştan gizleyen elemandır.  
**Ağırlık: 0,56 kg/m**

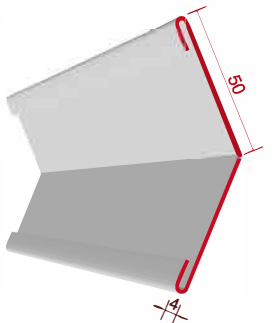



# Galvaniz Profiller (PG)

Galvaniz Profiller, galvaniz sacdan yapılır. Panellerin montajında bağlantı elemanı olarak kullanılır. Sac kalınlığı 1,5 mm'dir. 2400 mm standart boyda üretilir. Galvaniz profiller, gemi bünyesine doğrudan ya da ara elemanla kaynatılarak bağlanır.



## PG1 - Alt U Profili

B-0 tipi duvar panelini zemine bağlayan elemandır.

**Ağırlık:** 0,90 kg/m

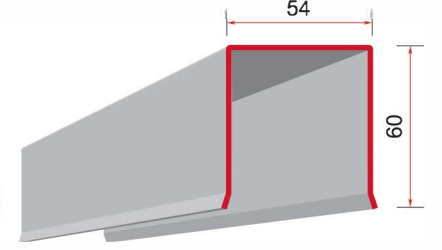
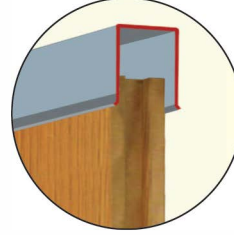
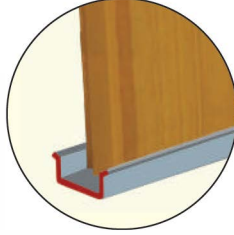

## PG4 - Üst U Profili

B-15 tipi duvar panelini tavana bağlayan elemandır.

**Ağırlık:** 2,01 kg/m

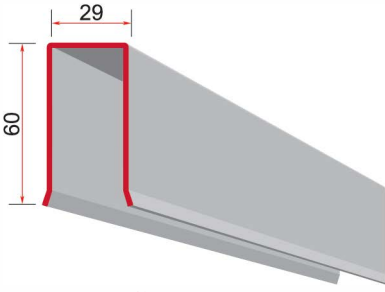

## PG2 - Üst U Profili

B-0 tipi duvar panelini tavana bağlayan elemandır.

**Ağırlık:** 1,72 kg/m

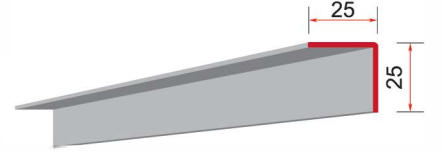
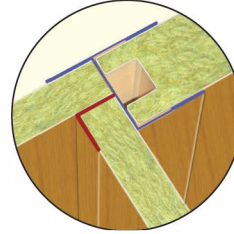
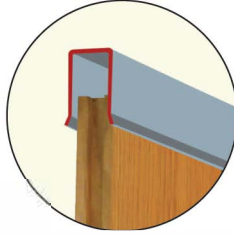

## PG5 - Köşebent Profili

Çok maksatlı montaj ve takviye profilidir.

**Ağırlık:** 0,55 kg/m

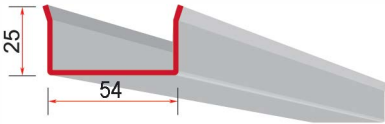

## PG3 - Alt U Profili

B-15 tipi duvar panelini zemine bağlayan elemandır.

**Ağırlık:** 1,20 kg/m

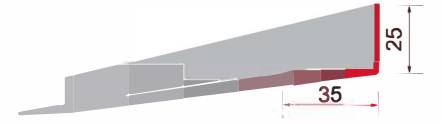
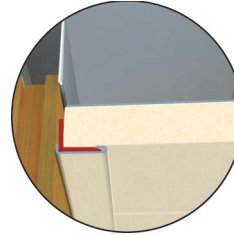
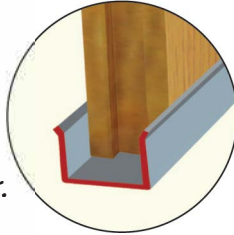

## PG7 - Tavan L Profili

Tavan-duvar bağlantı elemanıdır.

**Ağırlık:** 0,67 kg/m

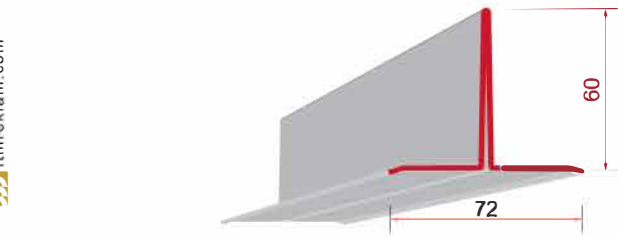

## PG8 - Tavan Askı Profili

Tavan panellerinin boyuna ek yerinde taşıyıcı eleman olarak kullanılır.

**Ağırlık:** 2,13 kg/m

