

Class B-15 Door

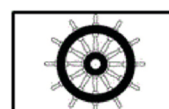

*It is used on Class
B-15 partition panels.*



2690 / 17



Technical Characteristics of Class B-15 Doors



Fire Class : B-15



Thickness : 42 mm



Standart Width (Clear Opening) : 700 mm



Standart Length (Clear Opening) : 1900 mm



Manufacturable Length (Clear Opening).... : 850 x 1750 mm
: 800 x 1900 mm
: 700 x 2000 mm



Surface Steel Sheet Thickness : 0,6 mm



Door Leaf Surface : PVC, GLV, SS



PVC Film : PVC film has “low flame spread” certificate



Insulation Materials : Mineral Wool - Rockwool / Denmark



Density of Rockwool : 130 kg/m³



Weight : ~59 kg/pc (700 x 1900 mm)



Application : It is mounted to Class B-15 partition panel



Certificate [IMO Resolution A.754(18)] :  Flag Authority (TC Maritime Undersecretary)



Bureau Veritas



Turk Loydu



MED Marine Equipment Directive (EC)

Assembling of Class B-15 Doors

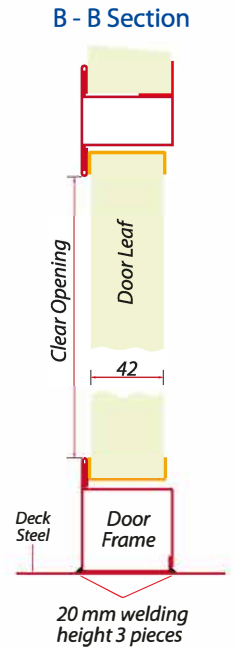
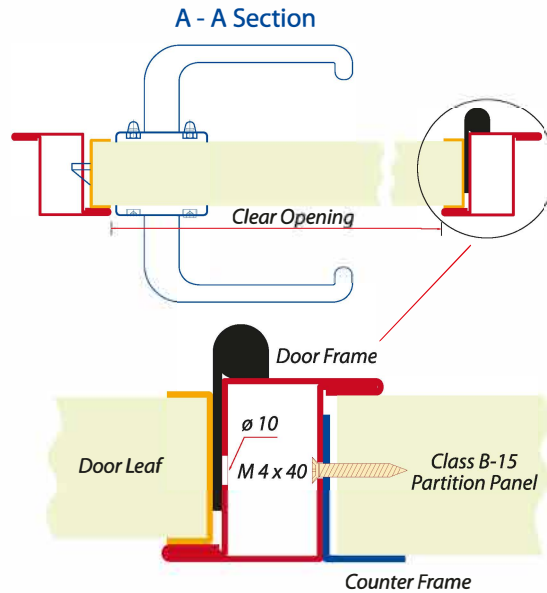
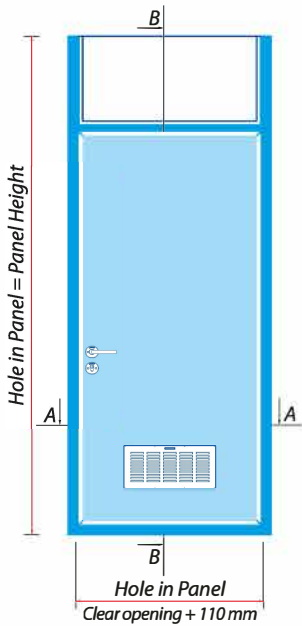

Assembling Rules

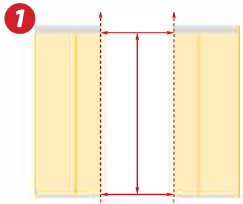

1 Please check whether panels out correct measurement and hole in panels is in the straight plane.

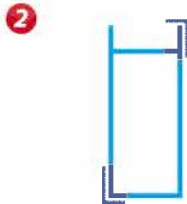

2 Check before door frames set square.

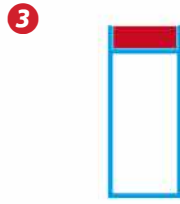

3 Put piece of panel.

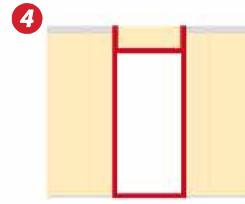

4 Put door frame to hole in panel.

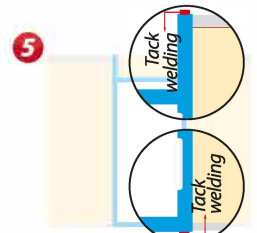

5 Tack weld below and upper parts of frame from hinged side to deck.

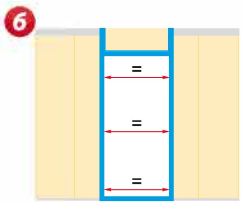

6 Measure frame middle and check whether the same with below and upper parts.

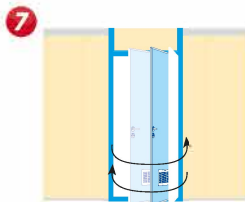

7 Fasten door leaf and check it is working good conditions or not.

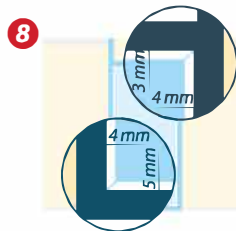

8 Please check distance between door leaf and door frame and fitted well or not each other.

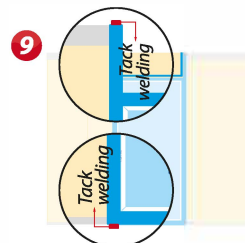

9 Tack weld below and upper parts of frame from lock-handle side to deck.

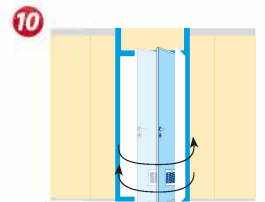

10 Check again door leaf is working in good conditions or not.

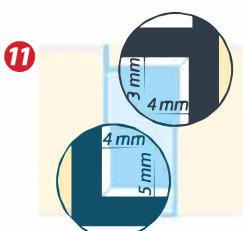

11 Please check again whether distance door leaf and door frame is regular or not.



12 If everthing is OK, mount counter frames.

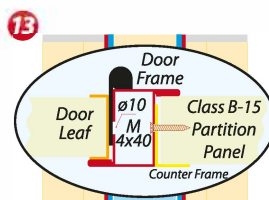

13 To screw door frame from fittings every connection of frame, counter frame and panel are well and tight.

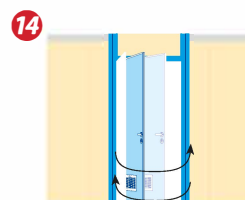

14 Please carry out your final controls.

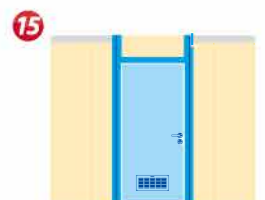

15 Mounting operations has been completed.

Advantages of Class B-15 Doors



Fast and easy assembling.



Door frames are **box shaped profile** and coated with **electrostatic dry powder painting.**



Locks are **protected inside with box shaped steel.**



Plenty of **color choice.**



Standart length manufacturing. Available to produce required dimensions.



Door leaf supported **strong skelton.**



PVC surface are covered with a **protective film** against dirty and straching.



Handles and rosettes are completely **stainless steel.**

No hanging down. **Three hinges.**

Hinges are produces from **stainless steel materials and uniqe part.**

Hinges areas are **supported from inside of door frame.**

Ventilotion grill use on standart models.

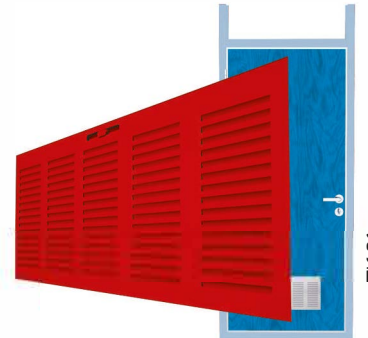
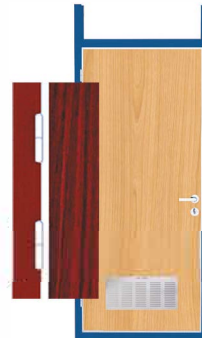

TK-21